

Side View

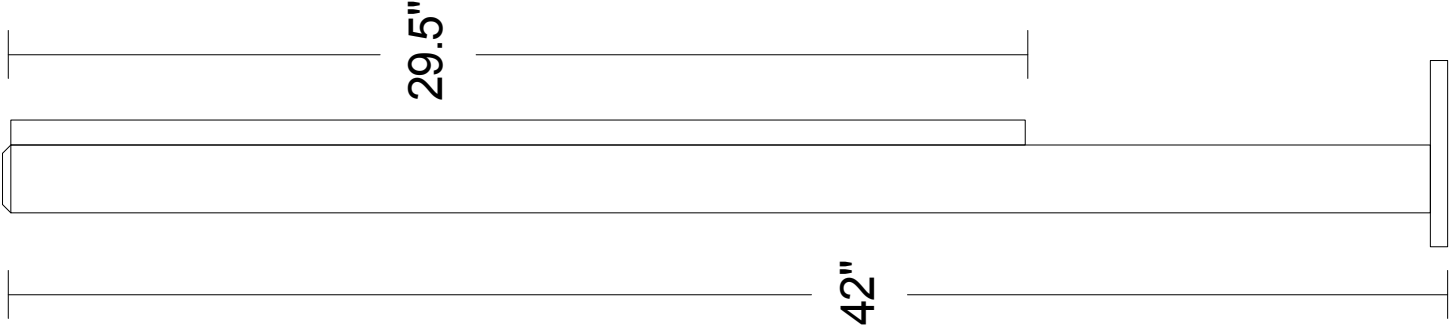

Front View

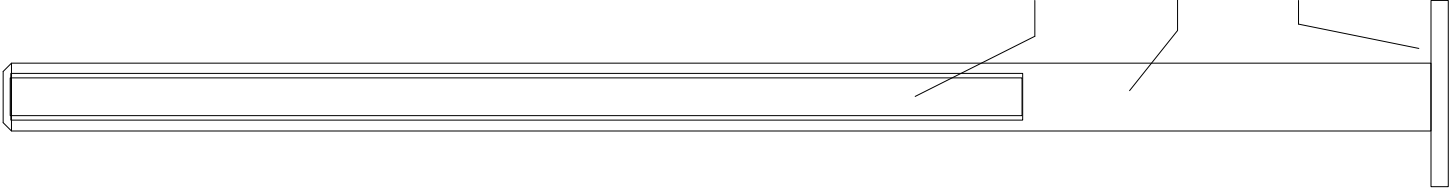

Fully welded steel construction with matte black powder coat finish.

Shown without barre mounting bracket attached.
When barre bracket is attached the barre height is adjustable from 20" to 45" from floor to top of barre.

.500" Mounting Holes

Barre Bracket
Height Adjustment Track

2"x2" x14 Gauge Steel
Square Tubular Post

6"x6"x.250" Steel
Base Plate

Enlarged Top View

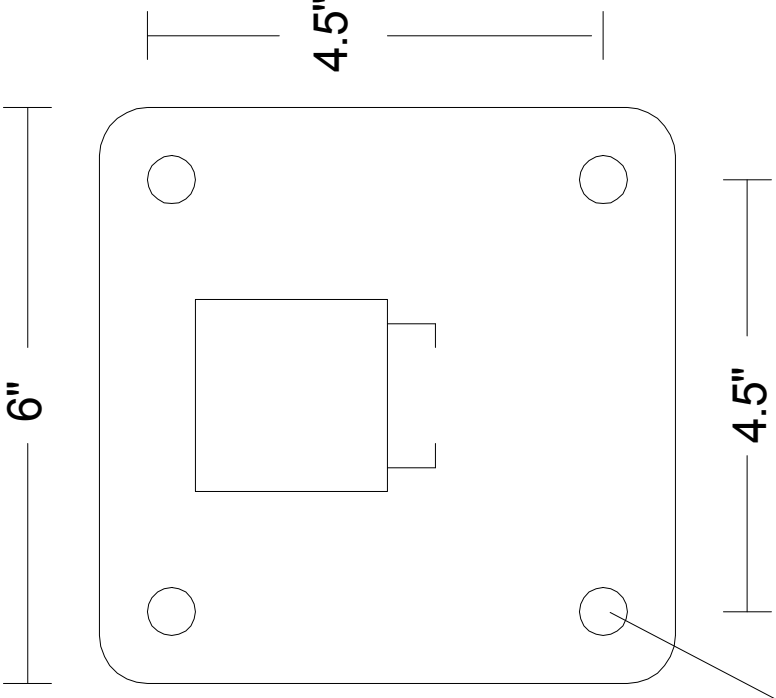

VITA VIBE, Inc. 40 Ellwood Ct. - Greenville, SC 29607 Tel: 864-288-8934 Fax: 864-751-6302		Proudly Manufactured In The USA	
PRODUCT: FS1 Floor Stanchion			
SCALE: None	DWG BY: LRE	DWG NO: 109136-2	DATE: 4/1/13
			REV: